

CES RFP 2010-001

Modular Mobile Classroom Structures

*Manufacturers Floor Plans and
Specifications for*

New Mexico

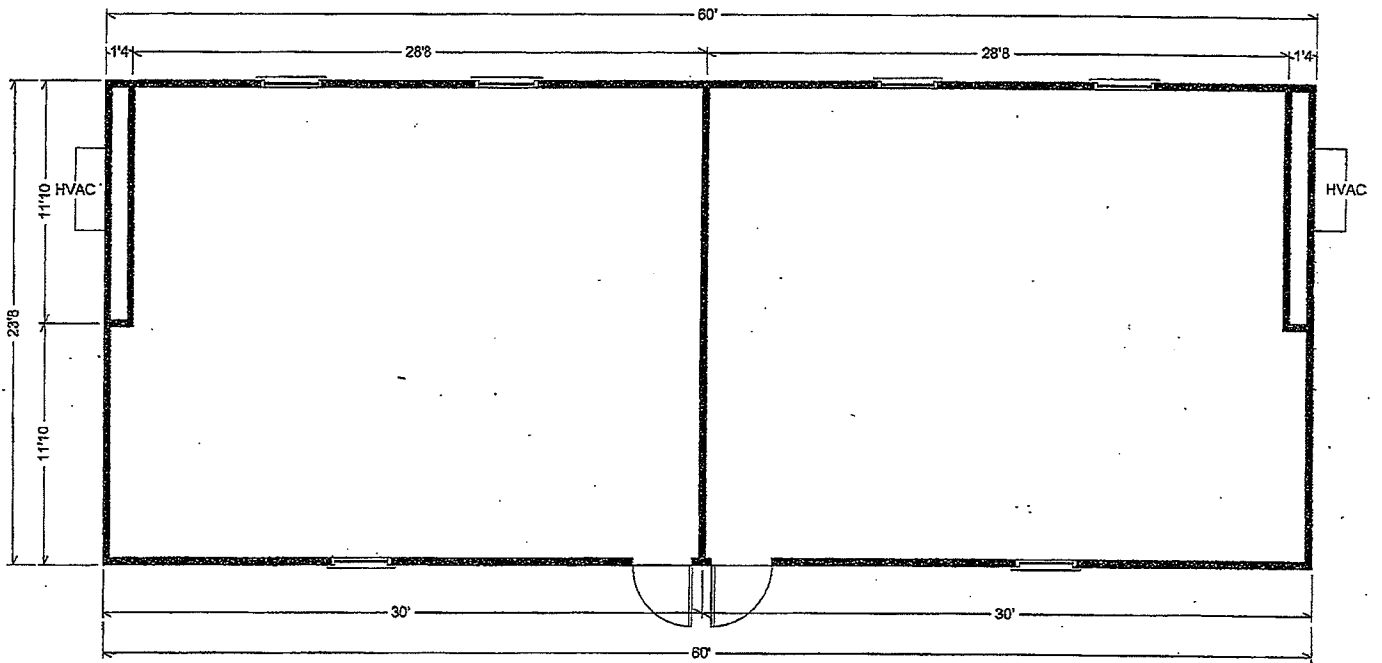

SPEC SHEETDate: 8/20/2009

Customer: _____

Location: _____

Project: A.E.P.A.Size: 24x64Description: Classroom

Modular

Insignias: New Mexico**MBI Seals - One per Module****DESIGN LOADS:**Floor: 50Wind: 90/CRoof: 30Foundation: Provided by others - (10) tie down straps included**FLOOR**Joists: 2x6 x 135 7/8 HF#2 @ 16" o/cRims: Continuous single 2x6Bottom Board: Reinforced PlasticInsulation: R-19 unfacedDecking (1st): 5/8 T&G Plywood**WALLS**Framing (EXT): 2x4 @ 16" o/c with continuous single 2x4 microllam top plateFraming (INT): 2x4 @ 16" o/cPlenum Walls: Standard for sound reduction - Lined with 5/8" sheetrockInsul-Exterior: R-13 KraftSiding: 7/16" L.P. Smart Panel 8" o/c grooves over barricade wrapTrims: Corners: L.P. Smart TrimMod line: L.P. Smart TrimFascia: L.P. Smart TrimDoors: L.P. Smart TrimWindows: L.P. Smart TrimSkirting: On site by others**ROOF**Framing: 2x6 @ 16" o/cRidgebeam: 30# Steel Clearspan with wood truss end supportsInsulation: R30 UnfacedSheathing: 1/2" APA rated sheathingCover: .045 Black EPDM fully adhered to 1/4" densdeck

DOORS

	EXT/INT	QTY	SIZE	TYPE	HINGES	FINISH	LOCK			
1	EXTERIOR	2	3'x6'8"	24 ga.		Bronze Jamb	Passage Locksets			

DOOR HARDWARE TO HAVE #626 SATIN CHROMIUM PLATED FINISH

WINDOWS

	EXT/INT	QTY	SIZE W x H	BRAND	HORIZONTAL SLIDER	GLAZING	FINISH	BLINDS	TINT
1	EXTERIOR	2	36"x48"	6200 series	X	DUAL LOW E	Bronze	MINI	Solar Gray Tint

INTERIOR FINISHES

Floors: Entire Building: 1/8" Armstrong Standard Excelon Tile

Walls: Entire Building: 1/2" Vinyl Covered Gypsum

Base: Entire Building: 4" Vinyl base trim

Trims: Walls: Vinyl wrap corners and batts

Windows: Vinyl wrap corners and batts

Doors: Vinyl wrap corners and batts

Ceiling: Entire Building: 2'x4' T-bar grid and tile - **Height: 8'-0" AFF**

Tile: Entire Building: T-bar tiles Armstrong #769

HVAC

Comb Heat/AC: (2) Standard Wall Mount 3 Ton A/C with 10kw Heat Strip

Supply Ducting: Fiberglass Ducting 28"x8"x10'

Diffuser: 24"x24" 4-Way Throw Diffuser 8" Collar w/Scoop and Damper

Thermostat: (2) Programmable - White Rogers 1F951277

Return Air: 24"x24" Return Air Grills w/14" Collar, 14" Flex Start Collar

ELECTRICAL

Service: 120/240V Single phase - Stub through exterior wall

Panel: (1) 200 amp

Material: Flex Conduit

Receptacles: (16) Duplex 20 amp
(2) Clock 15 amp
(2) 15 amp GFCI WP

Switches: (2) Single pole, (2) Dbl Single pole, (2) 3 Way switch

NOTE: **All devices and face plates to be ivory**

Light: (18) Troffer 2'x4' with (3) T-8 tubes and single electronic ballasts

Porch Light: (2) Photocell, Fluorescent, Heath/Zenith SL5680

Emergency Light: Wall Mount @ 88" AFF w/Battery Backup

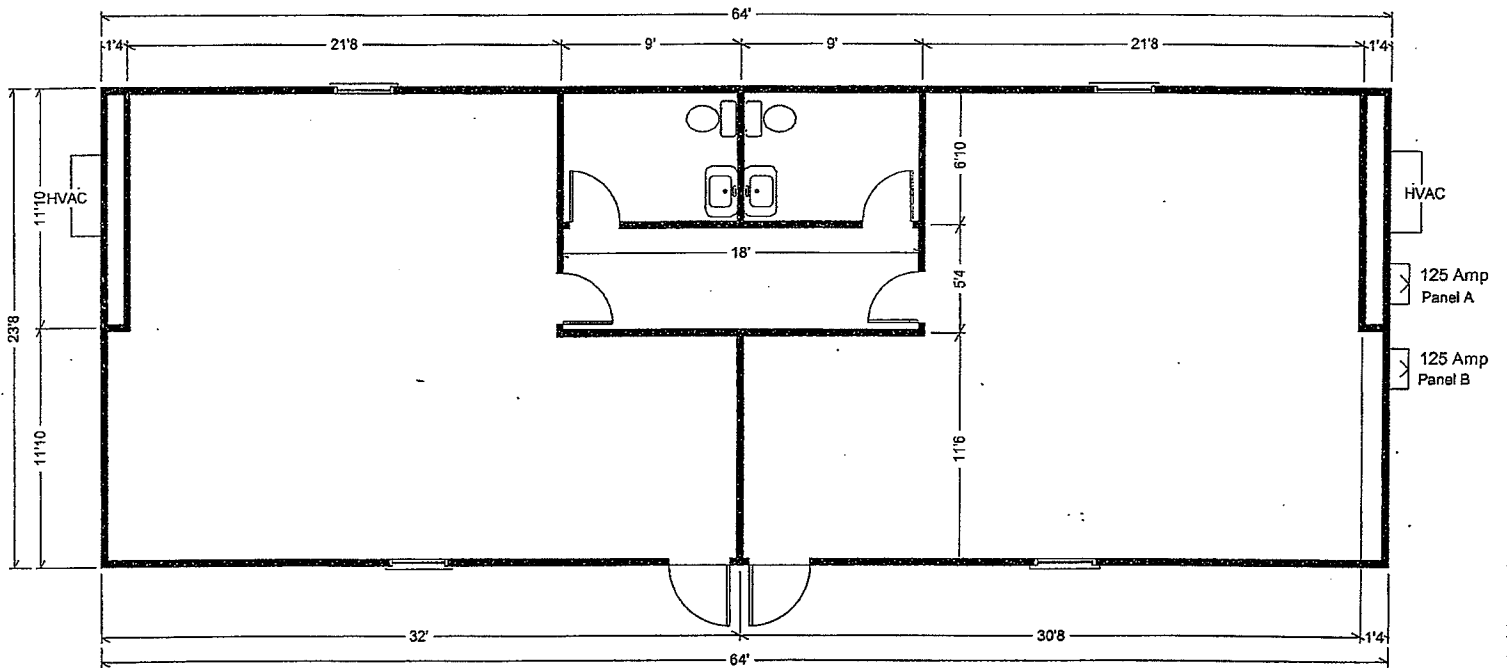

SPEC SHEET

Date: 8/20/2009
 Customer: _____
 Location: _____
 Project: A.E.P.A.

Size: 24x64
 Description: Classroom
 Modular
 Insignias: New Mexico

DESIGN LOADS:

Floor: 50
 Wind: 90/C
 Roof: 30

MBI Seals - One per Module

Foundation: Provided by others - (10) tie down straps included

FLOOR

Joists: 2x6 x 135 7/8 HF#2 @ 16" o/c
 Rims: Continuous single 2x6
 Bottom Board: Reinforced Plastic
 Insulation: R-19 unfaced
 Decking (1st): 5/8 T&G Plywood

WALLS

Framing (EXT): 2x4 @ 16" o/c with continuous single 2x4 microllam top plate
 Framing (INT): 2x4 @ 16" o/c
 Plenum Walls: Standard for sound reduction - Lined with 5/8" sheetrock
 Insul-Exterior: R-13 Kraft
 Siding: 7/16" L.P. Smart Panel 8" o/c grooves over barricade wrap
 Trims: Corners: L.P. Smart Trim
 Mod line: L.P. Smart Trim
 Fascia: L.P. Smart Trim
 Doors: L.P. Smart Trim
 Windows: L.P. Smart Trim
 Skirting: On site by others

ROOF

Framing: 2x6 @ 16" o/c
 Ridgebeam: 30# Steel Clearspan with wood truss end supports
 Insulation: R30 Unfaced
 Sheathing: 1/2" APA rated sheathing
 Cover: .045 Black EPDM fully adhered to 1/4" densdeck

DOORS

	EXT/INT	QTY	SIZE	TYPE	HINGES	FINISH	LOCK			
1	EXTERIOR	2	3'x6'8"	24 ga.		Bronze Jamb	Passage Locksets			

DOOR HARDWARE TO HAVE #626 SATIN CHROMIUM PLATED FINISH

WINDOWS

	EXT/INT	QTY	SIZE W x H	BRAND	HORIZONTAL SLIDER			GLAZING	FINISH	BLINDS	TINT
1	EXTERIOR	2	36"x48"	6200 series	X			DUAL LOW E	Bronze	MINI	Solar Gray Tint

INTERIOR FINISHES

Floors: Entire Building: 1/8" Armstrong Standard Excelon Tile

Walls: Entire Building: 1/2" Vinyl Covered Gypsum

Base: Entire Building: 4" Vinyl base trim

Trims: Walls: Vinyl wrap corners and batts

Windows: Vinyl wrap corners and batts

Doors: Vinyl wrap corners and batts

Ceiling: Entire Building: 2'x4' T-bar grid and tile - **Height: 8'-0" AFF**

Tile: Entire Building: T-bar tiles Armstrong #769

HVAC

Comb Heat/AC: (2) Standard Wall Mount 3 Ton A/C with 10kw Heat Strip

Supply Ducting: Firberglass Ducting 28"x8"x10'

Diffuser: 24"x24" 4-Way Throw Diffuser 8" Collar w/Scoop and Damper

Thermostat: (2) Programmable - White Rogers 1F951277

Return Air: 24"x24" Return Air Grills w/14" Collar, 14" Flex Start Collar

ELECTRICAL

Service: 120/240V Single phase - Stub through exterior wall

Panel: (1) 200 amp

Material: Flex Conduit

Receptacles: (16) Duplex 20 amp
(2) Clock 15 amp
(2) 15 amp GFCI WP

Switches: (2) Single pole, (2) Dbl Single pole, (2) 3 Way switch

NOTE: **All devices and face plates to be ivory**

Light: (18) Troffer 2'x4' with (3) T-8 tubes and single electronic ballasts

Porch Light: (2) Photocell, Fluorescent, Heath/Zenith SL5680

Emergency Light: Wall Mount @ 88" AFF w/Battery Backup

Restroom Option

Floors: Restrooms: Congoleum "Diamond" #9230 sheet vinyl

Walls: Restrooms: 1/2" Vinylwrap Tackboard "Calcutta Tan" over 5/8" Type-X sheetrock & PL wainscot per code

Base: Restrooms: 6" rubber

SPECIALTIES

Toilet Tissue:

(3) single roll

Mirror:

(2) 24"x36" - glass with no frame

Grab Bars:

(2) 18", (2) 36" & (2) 42"

Plumbing

HC Toilets:

(2) Handicap Height, Elongated Bowl, Pressure Assist

Gerber 21-318

Lavatory:

(2) 19 x 17 Wall Hung, One Piece Wall Hanger

Gerber 12-314

Lav. Faucet:

(2) Ceramic Disc, Hot Limit Stop, ADA Lever Handle

A/S 2385.404

Water Heater:

(1) 6 Gallon, 120 Volts, 1500 Watts, Energy Saver

Ruud PEP6-1

Sewer Lines:

PVC DWV Schedule 40 Plastic

Water Lines:

Copper & Aquapex

Exhaust Fans:

(2) 110 CFM - Switched with light